

**SCHMATIC**

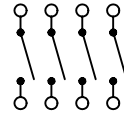

**SPECIFICATIONS**

**FUNCTION:**  
04x1P1T OFF-ON, Tape Sealed

**RATINGS:**  
Switching: 25mA 24VDC  
Steady: 100mA 50VDC

**ELECTRICAL LIFE:**  
2,000 Operations Per Switch

**CONTACT RESISTANCE:**  
Max. 50mΩ Initial

**INSULATION RESISTANCE:**  
100MΩ at 500VDC

**WITHSTAND VOLTAGE:**  
500VAC For 1 Minute

**CAPACITANCE:**  
5pF Max.

**SHOCK RESISTANCE:**  
Mil-Std. 202F, Method 213B  
Gravity: 50G, 11msec.  
Direction: 6 sides  
Times: 3 Each Direction  
High Reliability

**VIBRATION RESISTANCE:**  
Mil-Std. 202F, Method 201A  
Frequency: 10-55-10Hz/1 Minute  
Direction: X, Y, Z  
Time: 2 Hours Each Direction  
High Reliability

**OPERATING FORCE:**  
1000gf

**TEMPERATURE:**  
Operating: -20°C to 70°C  
Storage: -40°C to 85°C

**PACKAGING:**  
40 Pieces Per Tube

**COLORS**

**BODY:**  
Red

**ACTUATOR:**  
White

**MARKING COLOR:**  
White

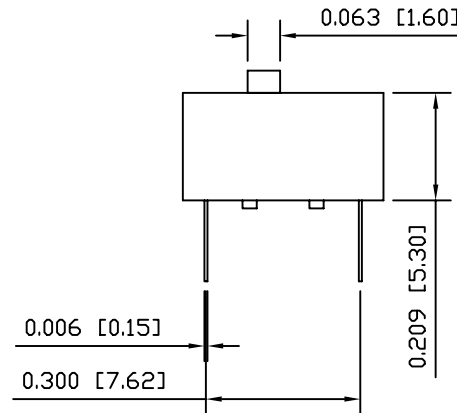
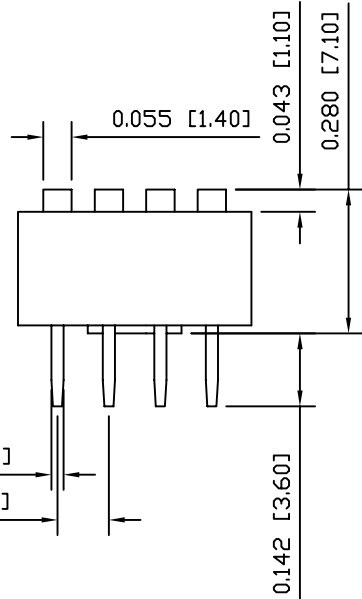

0.024 [0.60]  
0.100 [2.54]

0.006 [0.15]  
0.300 [7.62]

**SUGGESTED PCB LAYOUT**

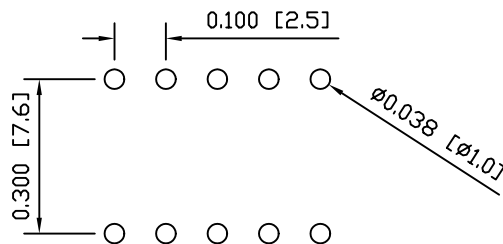

**MATERIALS**

**BASE:**  
Polybutylene Terephthalate, UL 94V-0

**COVER:**  
Polybutylene Terephthalate, UL 94V-0

**ACTUATOR:**  
Polybutylene Terephthalate, UL 94V-0

**TERMINALS:**  
Gold over Nickel Plated Phosphor  
Bronze.

**POTTING:**  
Epoxy

UNLESS OTHERWISE SPECIFIED, DIMENSIONS ARE IN INCHES [MILLIMETERS]	
TOLERANCES ARE:	
DEC .X±0.2	ANG ± 1°
.XXX±0.008	DRAWING NOT TO SCALE

**LAMB INDUSTRIES** P.O. Box 25110  
Portland, OR 97298

LAST REVISION:  
Apr. 01, 2004

DRAWING NUMBER: LDS-04-R-T-B

**LDS-04-R-T-B**