

SCHEMATIC

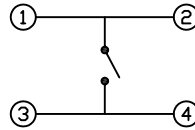

SPECIFICATIONS

FUNCTION:
1P1T OFF-(ON)

RATINGS:
50mA 12VDC

OPERATING FORCE:
160±50gf

TRAVEL:
0.010±0.004 [0.25±0.1]

CONTACT RESISTANCE:
Initial: 100mΩ Max.

INSULATION RESISTANCE:
100MΩ Min. at 500VDC

DIELECTRIC STRENGTH:
250VAC For 1 Minute

ELECTRICAL LIFE:
100,000 Cycles

SHOCK RESISTANCE:
Mil-Std. 202F, Method 213B

VIBRATION RESISTANCE:
Mil-Std. 202F, Method 201A

TEMPERATURE:
Operating: -25°C to 70°C
Storage: -30°C to 80°C

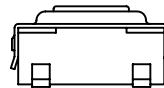
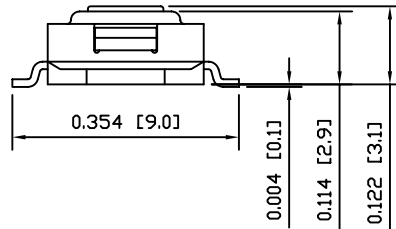

SUGGESTED PCB LAYOUT

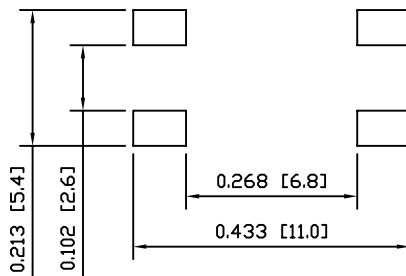

PACKAGING

TUBE

QUANTITY:
75 Pieces

MATERIALS

BASE:
Nylon Thermoplastic, UL94 V-0

COVER:
Stainless Steel

ACTUATOR:
Nylon Thermoplastic, UL94 V-0
Nickel Plated Brass

CONTACTS:
Stainless Steel

TERMINALS:
Silver Plated Brass



UNLESS OTHERWISE SPECIFIED,
DIMENSIONS ARE IN INCHES [MILLIMETERS]
TOLERANCES ARE:

DEC .X±0.2	ANG ± 1°
.XXX±0.008	DRAWING NOT TO SCALE
DRAWN BY: CARL BUCHHEIT	

LAMB INDUSTRIES P.O. Box 25110
Portland, OR 97298

LAST REVISION:
JAN. 16, 2007

DRAWING NUMBER: 06-TSM9W-3.1C-160-B.dwg

TSM9W-3.1C-160-B