

SUGGESTED PCB LAYOUT

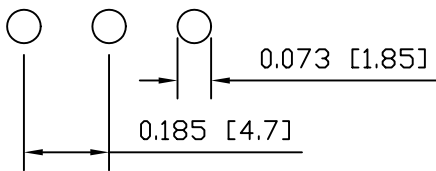

SPECIFICATIONS

FUNCTION:
1P2T ON-ON

RATINGS:
5A 125VAC/28VDC, 2A 250VAC

CONTACT RESISTANCE:
Max. 10mΩ

INSULATION RESISTANCE:
1,000MΩ Min.

DIELECTRIC STRENGTH:
1,500VAC

ELECTRICAL LIFE:
30,000 Cycles

OPERATING TEMPERATURE:
-30°C to 85°C

APPROVALS:



SCHEMATIC

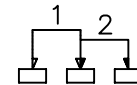

MATERIALS

BODY:
Dially Phthalate (DAP), UL 94V-0

BODY COVER:
Stainless Steel

ACTUATOR:
Nylon

CONTACTS:
Silver Plated Coin Silver

ELECTRICAL TERMINALS:
Silver Plated Copper Alloy

COLORS

BODY:
Red

BODY COVER:
Metallic

ACTUATOR:
Black



LAST REVISION:
MAY 6, 2003

DRAWING NUMBER: 17-1101-M2S3CQE2.dwg

UNLESS OTHERWISE SPECIFIED, DIMENSIONS ARE IN INCHES [MILLIMETERS]	
DEC .X±0.2	ANG ± 1°
.XXX±0.008	DRAWING NOT TO SCALE

1101-M2S3CQE2