

A

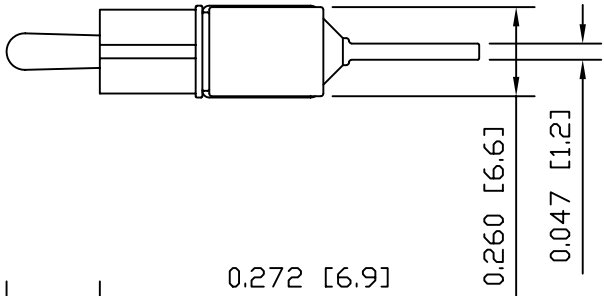

SCHEMATIC

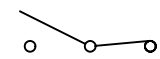

SPECIFICATIONS

FUNCTION:  
1P2T ON-ON

RATINGS:  
5A 125VAC  
2A 250VAC  
5A 28VDC

CONTACT RESISTANCE:  
10mΩ Max. at 2-4VDC

INSULATION RESISTANCE:  
1,000MΩ Min.

DIELECTRIC STRENGTH:  
1,500VAC at Sea Level

ELECTRICAL LIFE:  
50,000 Cycles at Full Load

OPERATING TEMPERATURE:  
-30°C to 85°C

B

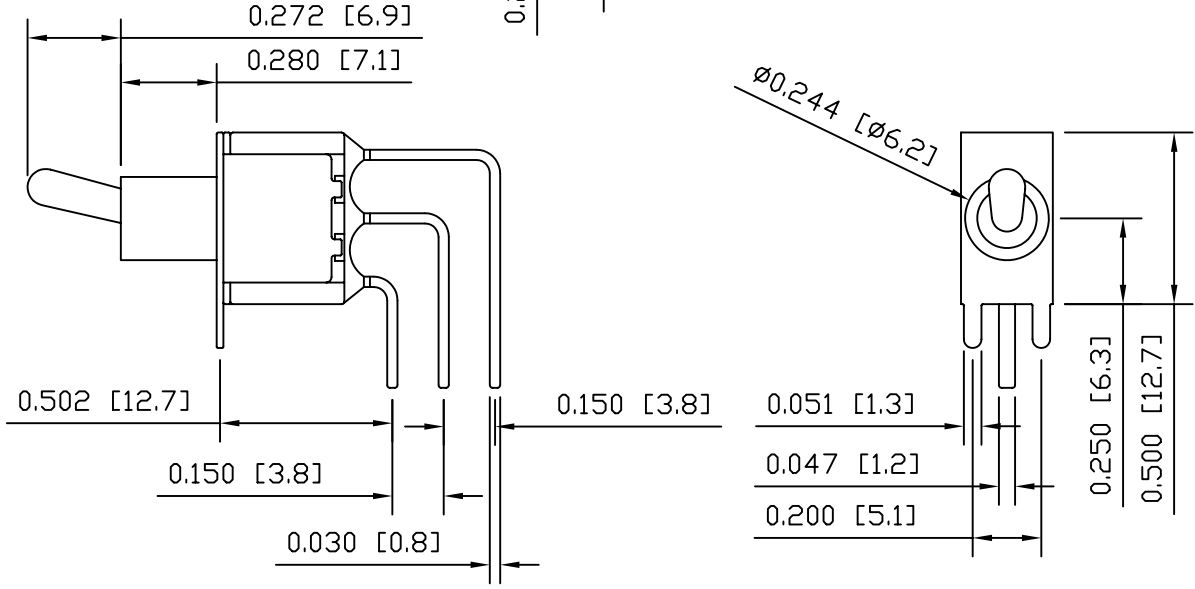

APPROVALS:



C

MATERIALS

BODY:  
Dially Phthalate (DAP), UL 94V-0

BODY COVER:  
Stainless Steel

ACTUATOR:  
Chrome Plated Brass

CONTACTS:  
Silver Plated Coin Silver

ELECTRICAL TERMINALS:  
Silver Plated Copper Alloy

SUGGESTED PCB LAYOUT

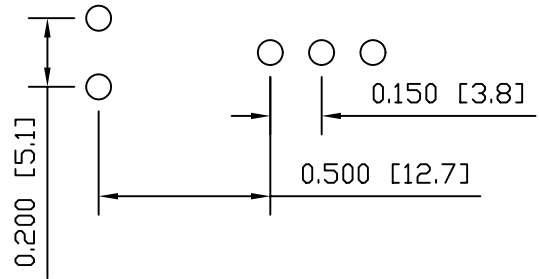

D

	P.O. Box 25110 Portland, OR 97298	LAST REVISION: APR. 30, 2004
	DRAWING NUMBER: 17-5101-P1D9AV2QE.dwg	
5101-P1D9AV2QE		

UNLESS OTHERWISE SPECIFIED,  
DIMENSIONS ARE IN INCHES [MILLIMETERS]  
TOLERANCES ARE:

DEC .X±0.2	ANG ± 1°
.XXX±0.008	DRAWING NOT TO SCALE