

SPECIFICATIONS

FUNCTION:
1P2T ON-ON

RATINGS:
5A 125VAC
2A 250VAC
5A 28VDC

CONTACT RESISTANCE:
Initial: 10mΩ Max. at 100mA 4VDC

INSULATION RESISTANCE:
1,000MΩ Min.

DIELECTRIC STRENGTH:
1,500VAC for 1 Minute

ELECTRICAL LIFE:
50,000 Cycles Min.

TEMPERATURE:
Operating: -30°C to 85°C

APPROVALS:



MATERIALS

BODY:
Diallyl Phthalate (DAP), UL94 V-0

BUSHING:
Nickel Plated Brass

BODY COVER:
Stainless Steel

ACTUATOR:
Chrome Plated Brass

CONTACTS:
Silver Plated Copper

TERMINALS:
Silver Plated Copper

TERMINAL SEALING:
Epoxy

COLORS

BODY:
Red

ACTUATOR:
Chrome

BUSHING:
Metallic

SCHEMATIC

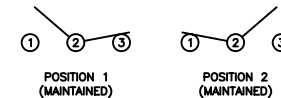

8

7

6

5

4

3

2

1



SUGGESTED PANEL CUTOUT **ALTERNATE PANEL CUTOUT**

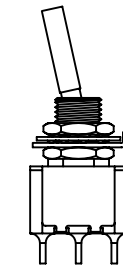
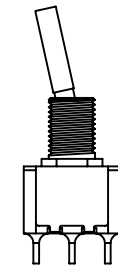
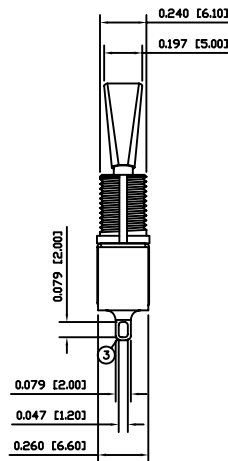
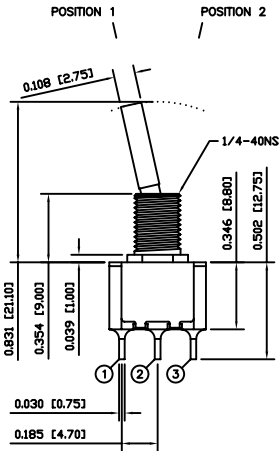
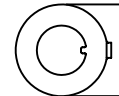
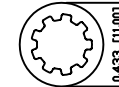
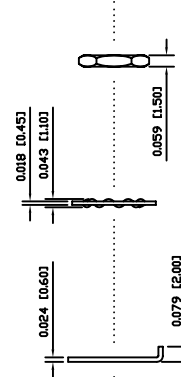
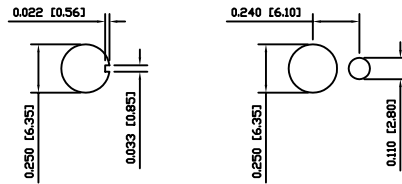

UNLESS OTHERWISE SPECIFIED,
DIMENSIONS ARE IN INCHES [MILLIMETERS]
TOLERANCES ARE:

DEC .X±0.2	ANG ± 1°
.XXX±0.008	DRAWING NOT TO SCALE
DRAWN BY: CARL BUCHHEIT	

LAMB INDUSTRIES P.O. Box 25110
Portland, OR 97298

LAST REVISION:
FEB. 16, 2007

DRAWING NUMBER: 17-5101-P3YZQE.dwg

5101-P3YZQE

8

7

6

5

4

3

2

1