

SPECIFICATIONS

FUNCTION:
2P2T ON-ON

RATINGS:
0.4VA Max. and 20V Max. (AC or DC)

CONTACT RESISTANCE:
10mΩ Max. at 2-4VDC

INSULATION RESISTANCE:
1,000MΩ Min.

DIELECTRIC STRENGTH:
1,500VAC at Sea Level

ELECTRICAL LIFE:
50,000 Cycles at Full Load

OPERATING TEMPERATURE:
-30°C to 85°C

APPROVALS:



MATERIALS

BODY:
Dially Phthalate (DAP), UL 94V-0

BODY COVER:
Stainless Steel

ACTUATOR:
Chrome Plated Brass

CONTACTS:
Gold Plating over Nickle Plated Brass

ELECTRICAL TERMINALS:
Gold Plating over Nickle Plated Brass

COLORS

BODY:
Red

BODY COVER:
Metallic

ACTUATOR:
Metallic

SCHEMATIC

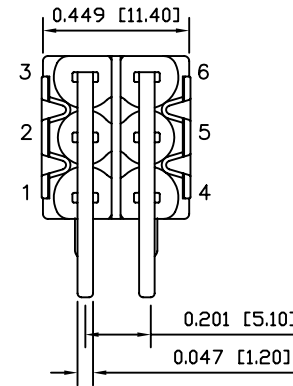
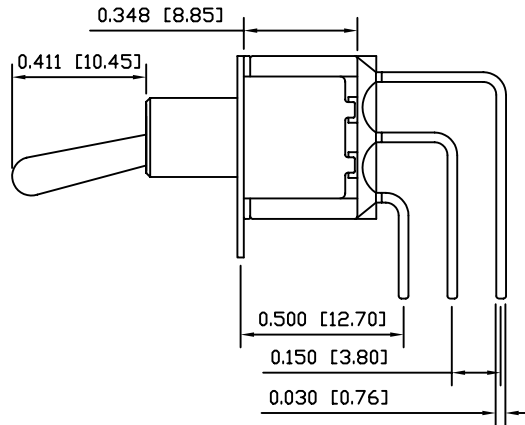
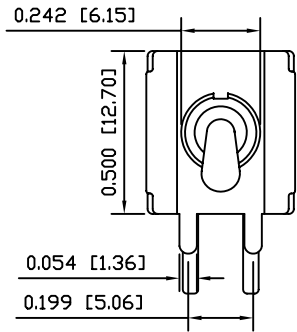
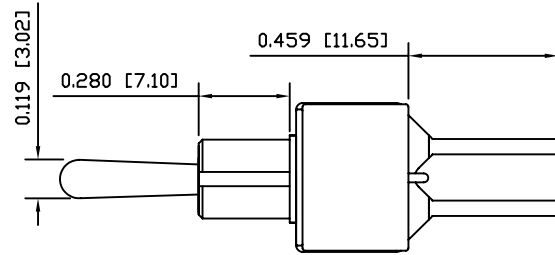
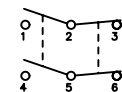

SUGGESTED PCB LAYOUT

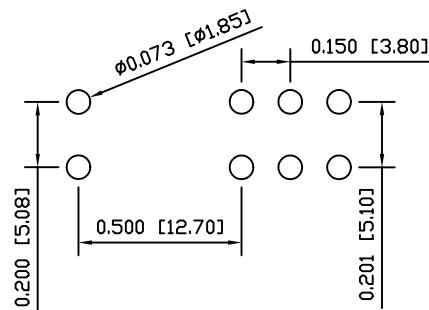

UNLESS OTHERWISE SPECIFIED, DIMENSIONS ARE IN INCHES [MILLIMETERS]	
DEC .X±0.2	ANG ± 1°
.XXX±0.008	DRAWING NOT TO SCALE

	P.O. Box 25110 Portland, OR 97298	LAST REVISION: JUNE 13, 2006
	DRAWING NUMBER: 17-5201-PSD9AV2BE.dwg	
5201-PSD9AV2BE		