

A

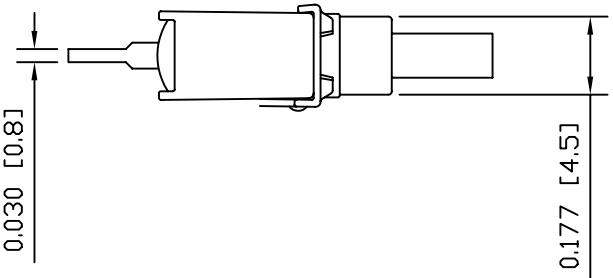

SCHEMATIC

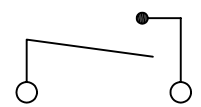

SPECIFICATIONS

FUNCTION:  
1P1T OFF-(ON)

RATINGS:  
0.4VA 20V (AC or DC) Max.

WATERPROOFING:  
IP67

CONTACT RESISTANCE:  
20mΩ Max. at 2-4VDC

INSULATION RESISTANCE:  
1,000MΩ Min.

DIELECTRIC STRENGTH:  
1,500VAC at Sea Level

ELECTRICAL LIFE:  
50,000 Cycles at Full Load

OPERATING TEMPERATURE:  
-30°C to 85°C

B

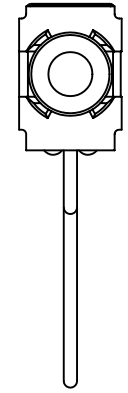
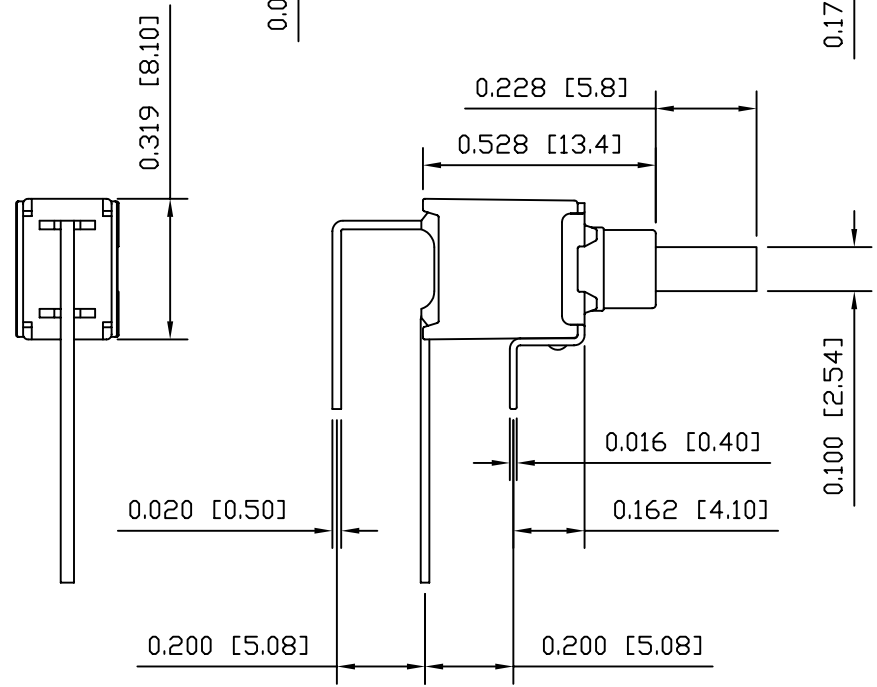

C

MATERIALS

BODY:  
Glass Filled Nylon 4/6, UL 94V-0

ACTUATOR:  
Thermoplastic Polyester, UL 94V-0

SUPPORT:  
Tin Plated Brass

CONTACTS:  
Gold Over Nickel Plated Copper Alloy

TERMINALS:  
Gold Over Nickel Plated Copper Alloy

D

SUGGESTED PCB LAYOUT

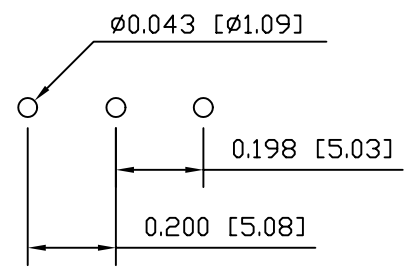

COLORS

BODY:  
Red

ACTUATOR:  
Black

UNLESS OTHERWISE SPECIFIED, DIMENSIONS ARE IN INCHES [MILLIMETERS]	
DEC .X±0.2	ANG ± 1°
.XXX±0.008	DRAWING NOT TO SCALE

LAMB INDUSTRIES P.O. Box 25110 Portland, OR 97298

LAST REVISION: JAN. 9, 2003

DRAWING NUMBER: 17-LP11-SD1AV2BE.dwg

LP11-SD1AV2BE