

SCHEMATIC

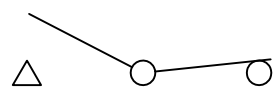

SPECIFICATIONS

FUNCTION:
1P2T ON-(ON)

RATINGS:
0.4VA Max. at 20VAC or DC Max.

WATERPROOFING:
IP67

CONTACT RESISTANCE:
20mΩ Max. at 2-4VDC

INSULATION RESISTANCE:
1,000MΩ Min.

DIELECTRIC STRENGTH:
1,500VAC at Sea Level

ELECTRICAL LIFE:
50,000 Cycles at Full Load

OPERATING TEMPERATURE:
-30°C to 85°C

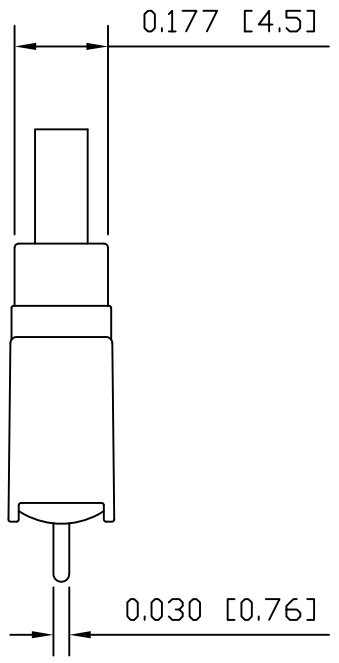
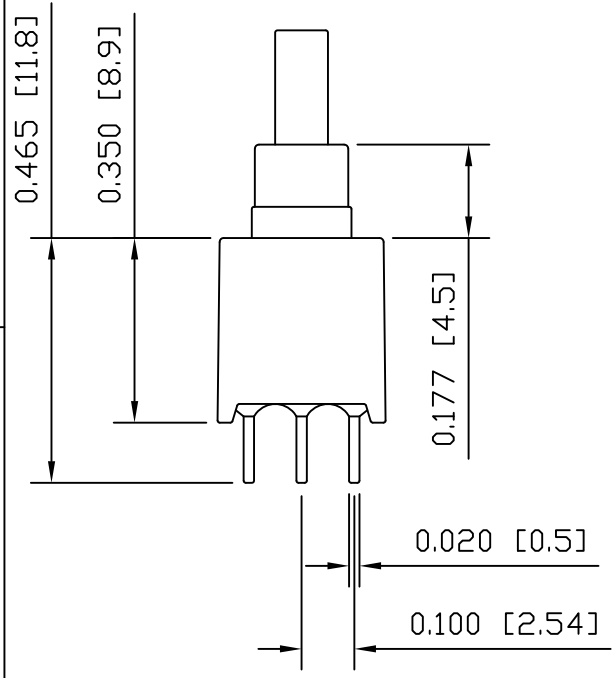

MATERIALS

BODY:
Glass Filled Nylon 4/6, UL 94V-0

ACTUATOR:
Thermoplastic Polyester, UL 94V-0

CONTACTS:
Gold Over Nickel Plated Copper Alloy

COMMON TERMINAL:
Gold Over Nickel Plated Copper Alloy

SUGGESTED PCB LAYOUT

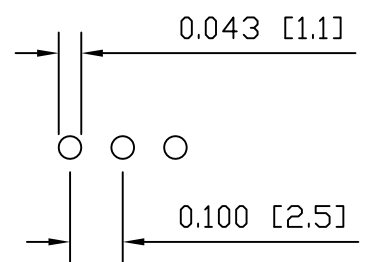

COLORS

BODY:
Red

ACTUATOR:
Black

LAMB INDUSTRIES P.O. Box 25110 Portland, OR 97298
LAST REVISION: MAY 08, 2008

UNLESS OTHERWISE SPECIFIED, DIMENSIONS ARE IN INCHES [MILLIMETERS]
TOLERANCES ARE:
DEC .X±0.2 ANG ± 1°
.XXX±0.008 DRAWING NOT TO SCALE

DRAWING NUMBER: 17-LP12-SD1CBE.dwg
LP12-SD1CBE