

COLORS

BODY:
White

ACTUATOR:
White

SPECIFICATIONS

FUNCTION:

1P2T ON-(ON)

RATINGS:

0.4VA Max. at 20V AC or DC Max.

CONTACT RESISTANCE:

Initial: 20mΩ Max. at 100mA 4VDC

INSULATION RESISTANCE:

1,000MΩ Min.

DIELECTRIC STRENGTH:

1,500VAC for 1 Minute

ELECTRICAL LIFE:

30,000 Cycles at Full Load

TEMPERATURE:

Operating: -30°C to 85°C

INGRESS PROTECTION:

IP67

APPROVALS:

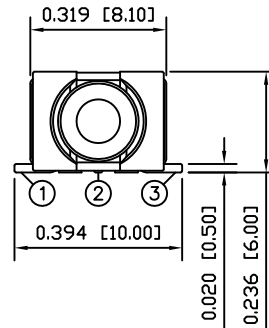
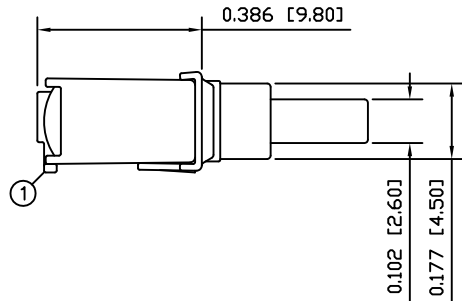

MATERIALS

BODY:

Glass Filled Nylon 4/6, UL94 V-0

ACTUATOR:

Carbon Fiber Filled Polyamide 4/6, UL94 V-0

SUPPORT:

Tin Plated Brass

CONTACTS:

Gold Over Nickel Plated Copper

TERMINALS:

Tin Coated Gold Over Nickel Plated Copper

TERMINAL SEAL:

Epoxy

SUGGESTED PCB LAYOUT

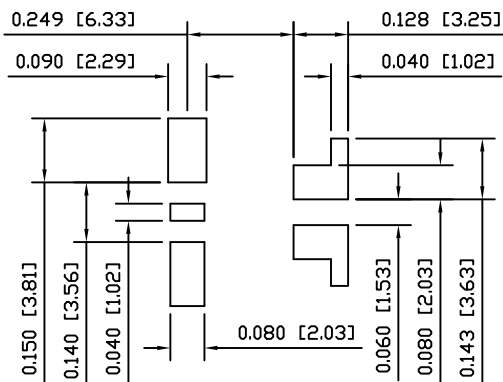

SCHEMATIC

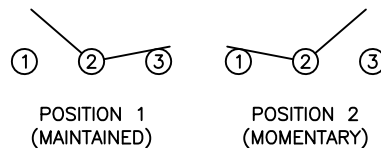

UNLESS OTHERWISE SPECIFIED,
DIMENSIONS ARE IN INCHES [MILLIMETERS]
TOLERANCES ARE:
DEC .X±0.2 ANG ± 1°
.XXX±0.008 DRAWING NOT TO SCALE
DRAWN BY: STACEY CHRISTIANSON

LAMB INDUSTRIES P.O. Box 25110
Portland, OR 97298

LAST REVISION:
MAY 08, 2008

DRAWING NUMBER: 17-LPS12-SD1SAKE.dwg

LPS12-SD1SAKE