

Suggested Panel Cutout

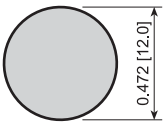

Maximum Panel Thickness: 0.138 [3,5]

FEATURES:

- Vandal Resistant
- Water Resistant
- Long Life Expectancy

SPECIFICATIONS:

RATING: 2A 48VDC
TEMPERATURE: -20°C to 70°C
ELECTRICAL LIFE: 200,000 Cycles
CONTACT RESISTANCE: 50mΩ Max. at 1A 12VDC
INSULATION RESISTANCE: 1,000MΩ Min. at 500VDC
DIELECTRIC STRENGTH: 2,000VAC for 1 Minute
INGRESS PROTECTION: IP65

MATERIALS:

BUSHING: Aluminum
 Nickel Plated Brass
 Stainless Steel
ACTUATOR: Polybutylene Terephthalate, UL94 V-2
 Nickel Plated Brass
 Stainless Steel
BASE: Polybutylene Terephthalate, UL94 V-2
SEALING: Silicone
INNER ASSEMBLY: Polyamide 6/6
 Brass
SPRING: Steel
CONTACT: Silver Plated Brass
TERMINALS: Silver Plated Brass
 Steel
HARDWARE: Brass

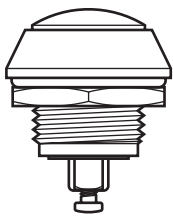
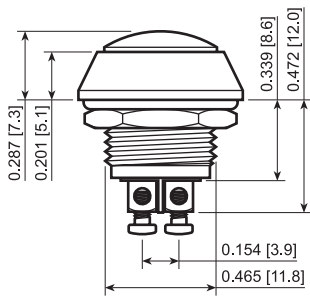

PV5S64012



PV5S640SS



PV5S64017
PV5S64018

SPECIFICATIONS SUBJECT TO CHANGE WITHOUT NOTICE

Series	Actuator Options	Terminal	Function	Rating	Body Color	Actuator Color	Contact Material
PV5	S - Domed	6 - Screw	4 - Off-(On)	0 - 2A 48VDC	1 - Black N - Nickel S - Stainless Steel	1 - Black 2 - White 6 - Yellow 7 - Blue 8 - Green 9 - Red N - Nickel S - Stainless Steel	None - Silver G - Gold

STANDARD PART NUMBERS:

- PV5S64011** 1P Off-(On)
Domed Black Actuator, Silver Contacts
- PV5S64012** 1P Off-(On)
Domed White Actuator, Silver Contacts
- PV5S64012G** 1P Off-(On)
Domed White Actuator, Gold Contacts
- PV5S64016** 1P Off-(On)
Domed Yellow Actuator, Silver Contacts
- PV5S64017** 1P Off-(On)
Domed Blue Actuator, Silver Contacts
- PV5S64018** 1P Off-(On)
Domed Green Actuator, Silver Contacts
- PV5S64019** 1P Off-(On)
Domed Red Actuator, Silver Contacts
- PV5S64019G** 1P Off-(On)
Domed Red Actuator, Gold Contacts